

IDENTIFICATION SURVEY REPORT

DATE	29 July 2021
REFERENCE	21640
SENT	ashlee@perceptionplanning.com.au

ATTENTION

Amber & Danny Woodland
C/- Perception Planning

REGARDING PROPERTY

310 Pinebrush Road, Glen Martin

DEAR AMBER & DANNY,

Acting in accordance with your instructions we have undertaken a survey, for identification purposes only, of part of Lot 31 in Deposited Plan 733190, being the land contained in Folio Identifier 31/733190 in the Local Government Area of Dungog, Parish of Horton, County of Gloucester, State of New South Wales. The subject property is known as 310 Pinebrush Road, Glen Martin.

The survey and report are limited to the metal sheds shown on the sketch only.

In my opinion, the sheds stand wholly within the boundary of the subject land. Offsets from the sheds to the boundary of the subject land are shown on the sketch attached.

No investigation has been undertaken to determine the existence of any other possible encroachments, including subterranean encroachments, by or upon the subject land.

Please do not hesitate to contact me should you require anything further.

Kind Regards



Tom Campbell
Registered Surveyor

Surveyor Registered under the Surveying and Spatial Information Act 2002



IDENTIFICATION SKETCH

LOT 31 DP733190
310 PINE BRUSH ROAD, GLEN MARTIN

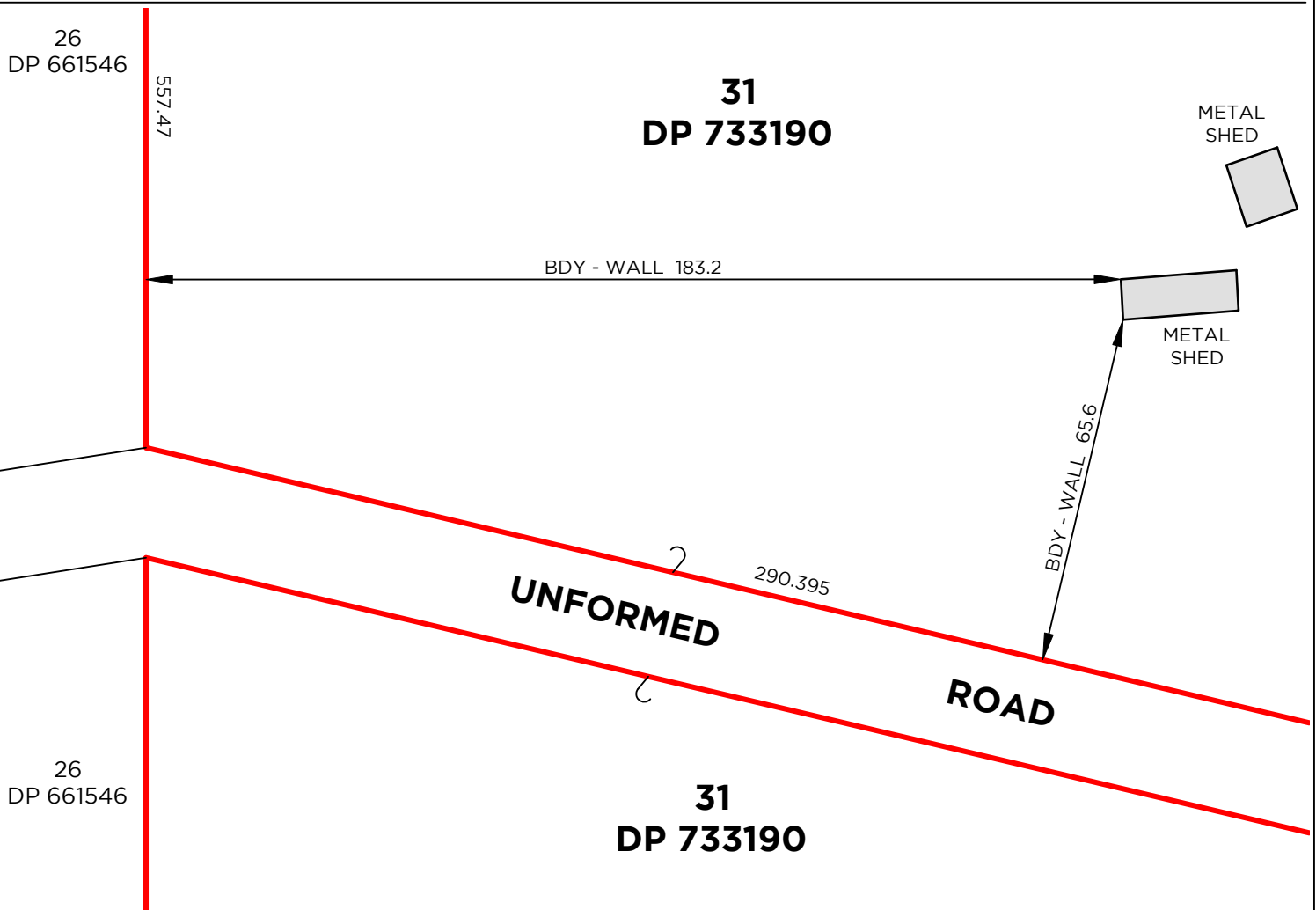
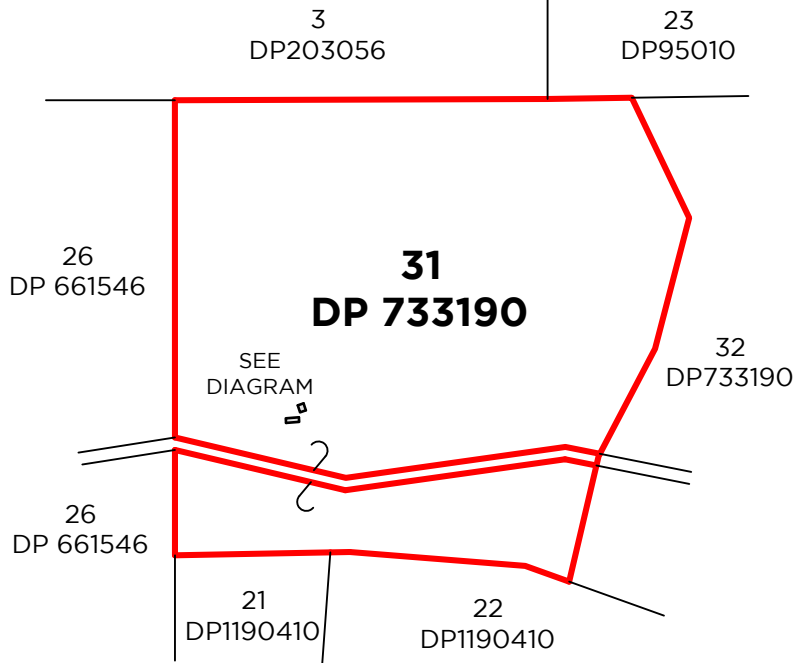

**DELFS
LASCELLES**
CONSULTING SURVEYORS

DIAGRAM
RR 1:1,250

TOM CAMPBELL
REGISTERED SURVEYOR